

机械手收料机2000
Manipulator receiver 2000



性能优势

有效载荷6KG臂展2001mm,设计结构紧凑。工作空间大,运行速度快,重复定位精度高大大提高生产效率。

Performance advantage

The payload is 6KG, the arm span is 2001mm, and the design is compact. The working space is large, the running speed is fast, and the repeated positioning accuracy is high, which greatly improves the production efficiency.

效率

可以减少一个人工

Efficient

One manpower can be reduced

适用范围

适用于纺织收料

Scope of application

Suitable for textile receiving

机器人外形尺寸和最大动作范围图

Robot Dimensions and Maximum Action Range Diagram

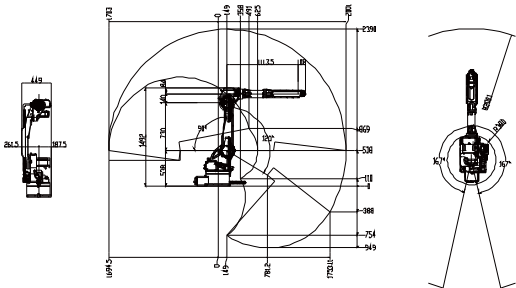

视频及资料下载
Video and data download

最大臂展Maximum wingspan	2001mm	气压 Air pressure	0.5Mpa
轴数Number of axes	6	电控柜重量Electric control cabinet weight	130Kg
有效载荷Payload	6Kg	电控柜尺寸Electric control cabinet sizes	580×600×960mm(L×W×H)
电压 Voltage	三相四线Three-phase four-wire 380V		

以上基础参数表为标准款机型